

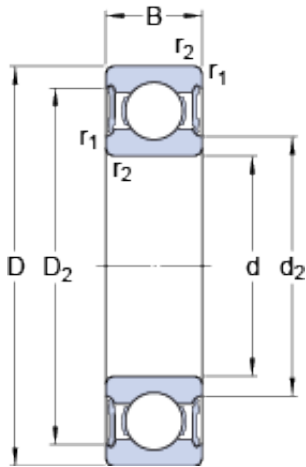

# BEARING BOWER CORP.



17 mm x 30 mm x 7 mm DAC35720434 Left Rear Wheel Hub Bearing 35x72.04x34mm

Bearing No. 61903-2RS1

61903-2RS1 Bearing 2D drawings and 3D CAD models

Size	30x17x7 mm
Bore Diameter	30 mm
Outer Diameter	17 mm
Width	7 mm
d	17 mm
D	30 mm
B	7 mm
d <sub>2</sub>	19.4 mm
D <sub>2</sub>	27.7 mm
r <sub>1,2</sub> - min.	0.3 mm
d <sub>a</sub> - min.	19 mm
d <sub>a</sub> - max.	19.3 mm
D <sub>a</sub> - max.	28 mm
r <sub>a</sub> - max.	0.3 mm
Basic dynamic load rating - C	4.6 kN
Basic static load rating - C <sub>0</sub>	2.6 kN
Fatigue load limit - P <sub>u</sub>	0.108 kN
Limiting speed	14000 r/min
Calculation factor - k <sub>r</sub>	0.02
Calculation factor - f <sub>0</sub>	14.7
Category	Single Row Ball Bearings
Inventory	6.0
Manufacturer Name	SKF
Minimum Buy Quantity	N/A



## BEARING BOWER CORP.

Weight / Kilogram	0.019
EAN	7316577121936
Product Group	B00308
Enclosure	2 Seals
Precision Class	ABEC 1   ISO P0
Maximum Capacity / Filling Slot	No
Rolling Element	Ball Bearing
Snap Ring	No
Internal Special Features	No
Cage Material	Steel
Enclosure Type	Contact Seal
Internal Clearance	C0-Medium
Inch - Metric	Metric
Long Description	17MM Bore; 30MM Outside Diameter; 7MM Outer Race Diameter; 2 Seals; Ball Bearing; ABEC 1   ISO P0; No Filling Slot; No Snap Ring; No Internal Special Features
Category	Single Row Ball Bearing
UNSPSC	31171504
Harmonized Tariff Code	8482.10.50.68
Noun	Bearing
Keyword String	Ball
Manufacturer URL	<a href="http://www.skf.com">http://www.skf.com</a>
Manufacturer Item Number	61903 2RS1
Weight / LBS	0.04
Outer Race Width	0.276 Inch   7 Millimeter
Bore	0.669 Inch   17 Millimeter
Outside Diameter	1.181 Inch   30 Millimeter
bore diameter:	17 mm
static load capacity:	2.55 kN



## BEARING BOWER CORP.

outside diameter:	30 mm
precision rating:	Not Rated
overall width:	7 mm
finish/coating:	Uncoated
bore type:	Round
cage material:	Steel
closure type:	Double Sealed
outer ring width:	7 mm
row type & fill slot:	Single Row Non-Fill Slot
fillet radius:	0.3 mm
internal clearance:	C0
maximum rpm:	14000 RPM
operating temperature range:	-40 to +210 ° F
series:	61
dynamic load capacity:	4.62 kN
$d_2$	19.4 mm
$D_2$	27.7 mm
$r_{1,2}$ min.	0.3 mm
$d_a$ min.	19 mm
$d_a$ max.	19.3 mm
$D_a$ max.	28 mm
$r_a$ max.	0.3 mm
Basic dynamic load rating C	4.62 kN
Basic static load rating $C_0$	2.55 kN
Fatigue load limit $P_u$	0.108 kN
Calculation factor $k_r$	0.02
Calculation factor $f_0$	14.7
Mass bearing	0.017 kg