

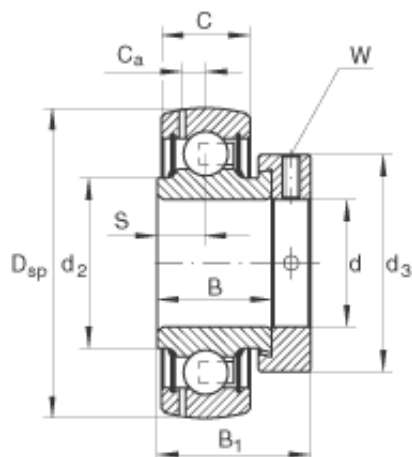

BEARING BOWER CORP.



578815 Taper Roller Bearing 390x568x180mm

Bearing No. GRAE17-NPP-B

Size	17x40x28.6 mm
Bore Diameter	17 mm
Outer Diameter	40 mm
Width	28,6 mm
d	17 mm
D _{SP}	40 mm
B ₁	28,6 mm
B	19 mm
C	12 mm
C _a	3,4 mm
d ₂	23 mm
d _{3 max}	28 mm
S	6,5 mm
W	3 mm
m	0,1 kg / Weight
C _r	10100 N / Dynamic load rating (radial)
C _{0r}	4750 N / Static load rating (radial)
Category	Insert Bearings Spherical OD
Inventory	6.0
Manufacturer Name	SCHAEFFLER GROUP
Minimum Buy Quantity	N/A
Weight / Kilogram	0.144
EAN	4012802800883

GRAE17-NPP-B Bearing 2D drawings and 3D CAD models



BEARING BOWER CORP.

Product Group	M06110
Inner Race Profile	Narrow Inner Ring
Outer Race Profile	Spherical
Relubricatable	Yes
Seal Type	Double Lip Contact
Mounting Method	Eccentric Collar
Rolling Element	Ball Bearing
Snap Ring	No
Long Description	17MM Bore; Narrow Inner Ring; Ball Bearing; 28.6MM Length Thru Bore; 12MM Outer Race Width; 40MM Outside Diameter; Relubricatable; Double Lip Contact Seal; Eccentric Collar Mounting Method; No Snap Ri
Inch - Metric	Metric
Other Features	Single Row With Set Screw Metric
Category	Insert Bearings
UNSPSC	31171536
Harmonized Tariff Code	8482.10.50.00
Noun	Bearing
Keyword String	Insert
Manufacturer URL	http://www.ina.com
Manufacturer Item Number	GRAE17NPPB
Weight / LBS	0.375
Outer Race Width	0.472 Inch 12 Millimeter
Outside Diameter	1.575 Inch 40 Millimeter
Length Thru Bore	1.126 Inch 28.6 Millimeter
Bore	0.669 Inch 17 Millimeter