

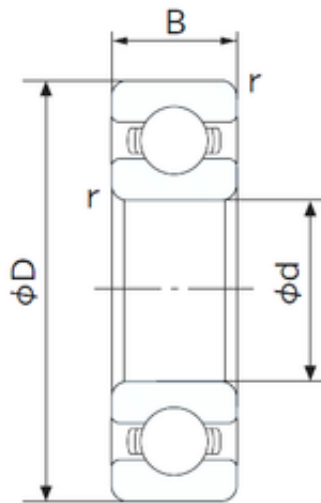

## BEARING BOWER CORP.



6002 2RS 6002 Zz Z1V1 Z2V2 Z3V3 ISO Deep Groove Ball Bearing SKF NSK NTN NACHI Koyo OEM

Bearing No. 6002

Size	15x32x9 mm
Bore Diameter	15 mm
Outer Diameter	32 mm
Width	9 mm
d	15 mm
D	32 mm
B	9 mm
C	9 mm
r min.	0.3 mm
da min.	17 mm
Da max.	30 mm
ra max.	0.3 mm
Weight	0.032 Kg
Basic dynamic load rating (C)	5,6 kN
Basic static load rating (C0)	2,84 kN
(Grease) Lubrication Speed	23000 r/min
Enclosure	Open
Bore Type	Cylindrical Bore
Configuration	Single Row
Bore Size	15 mm
Outside Diameter	32 mm
Width	9 mm
Fillet Radius/Chamfer	0.3 mm
Dynamic Load Rating	5,600 N

6002 Bearing 2D drawings and 3D CAD models



## BEARING BOWER CORP.

Static Load Rating	2,840 N
Limiting Speed - Grease	24,000 rpm
Limiting Speed - Oil	28,000 rpm
Factor $f_0$	13.9
Radial Clearance	0.003 to 0.018 mm
da (min)	17 mm
Da (max)	30 mm
ra (max)	0.3 mm